



V243 SERIES 2 WAY VALVE BODY

1/2", 3/4" and 1" with Threaded Female Inlet and Outlet Ports

Spartan Peripheral Devices 2 way V243 series globe control valve bodies, with female inlet and outlet ports, are available in 1/2", 3/4" and 1" sizes.

They are designed for hot or chilled water and 50% glycol with a standard EP cartridge, or for high differential pressure applications with a balanced EB cartridge and for low pressure steam applications up to 15PSI with a steam rated EV cartridge. See Spartan cartridges data sheet.

They are compatible and interchangeable with the complete line of Spartan control valve actuators (wireless, electric, electronic, pneumatic and thermostatic). See Spartan actuators data sheet.

The commercial application globe valve bodies utilize low zinc antidezincification bronze and are guaranteed for the life of the building.

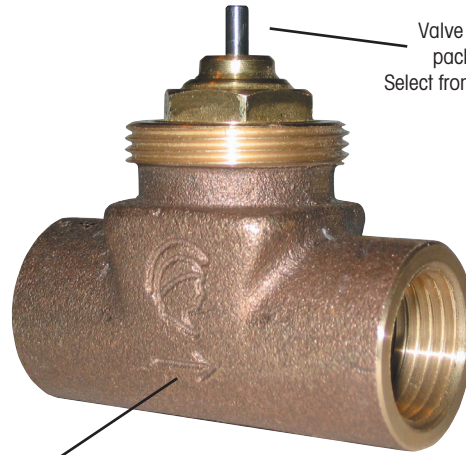

Valve shown with removable packing cartridge installed. Select from type and application.

The valve body must be installed in the direction indicated on the valve body cavity.

GENERAL SPECIFICATIONS

Body Material: Low zinc bronze, alloy C84400

Pressure Rating: ANSI 250 (400 PSI at 32°F to 150°F, 250 PSI at 250° F) PN25

Max. Test Pressure: 1200 PSI (81 bar)

Max. Δ Pressure: 50 PSI (3.5 bar) can be exceeded but with possible water noise

Valve Stem: "Mirror – maker" burnished 303 stainless steel stems

Rangeability: 100:1

Stem Travel: 5/32" (4mm)

Stem Position: UP = valve open (default position), DOWN = valve closed

Available CVs 1/2" & 3/4": 0.15, 0.50, 1.00, 1.50, 2.00, 2.50, 3.00, 3.50, 4.50

Available CVs 1": 6.00, 6.40, 8.00, 9.00

See Cartridge Data Sheet for different applications

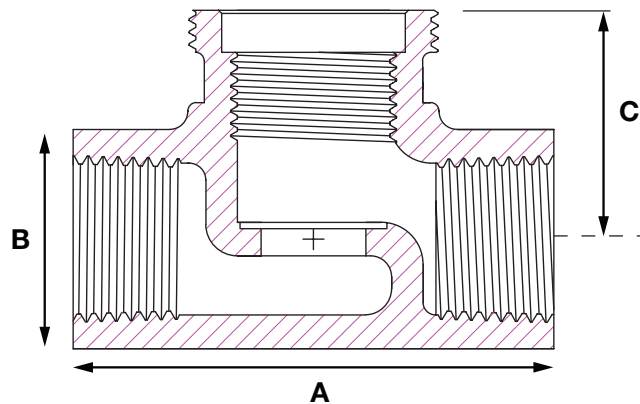

INSTALLATION INSTRUCTIONS

When installing it is essential that the flow follows the arrow that is embedded into the valve body casting. The packing, plunger and cartridge can be easily replaced by using the AV08 Packing Wrench.

This product must not be used outside of the specified applications. Installation should only be carried out by a licensed and trained installer.

All local regulations and codes must be followed, and complied with, during the installation of this product.

DIMENSIONS

Select the required valve size:

V243-12N for 1/2" size.

V243-34N for 3/4" size.

V243-10N for 1" size.

Select CV from cartridge type.

DIMENSIONS

	A	B	C
1/2" Valve V243-12	2.29 (58,17)	1.60 (40,64)	1.09 (27,69)
3/4" Valve V243-34	2.70 (68,58)	2.20 (55,88)	1.09 (27,69)
1" Valve V243-10	3.88 (98,50)	2.84 (71,10)	1.80 (45,70)

HOW TO ORDER

1. Choose your valve body.
2. Choose an internal cartridge according to your application and CV. See Spartan cartridges data sheet.
3. Choose an actuator.

For a complete overview, see our

Zone Valve Selection Guide.



ACTUATOR TYPE: see Data Sheets

SELECT Cv VALUE

CARTRIDGE TYPE: see Cartridge Data Sheet

N = NPT threads, **B** = BSPT (tapered threads)

VALVE SIZE: 12 = 1/2", 34 = 3/4", 10 = 1"

VALVE BODY TYPE: VE243 = female threaded port in, female threaded port out

VALVE ASSEMBLY TYPE: Select **E** for Electric, **P** for Pneumatic, or **T** for Thermostatic